

* Utilization of this area is subjected to acquisition of land by ABRPL, which is required for ensuring connectivity
 # Low lying area, required to be filled up for utilization

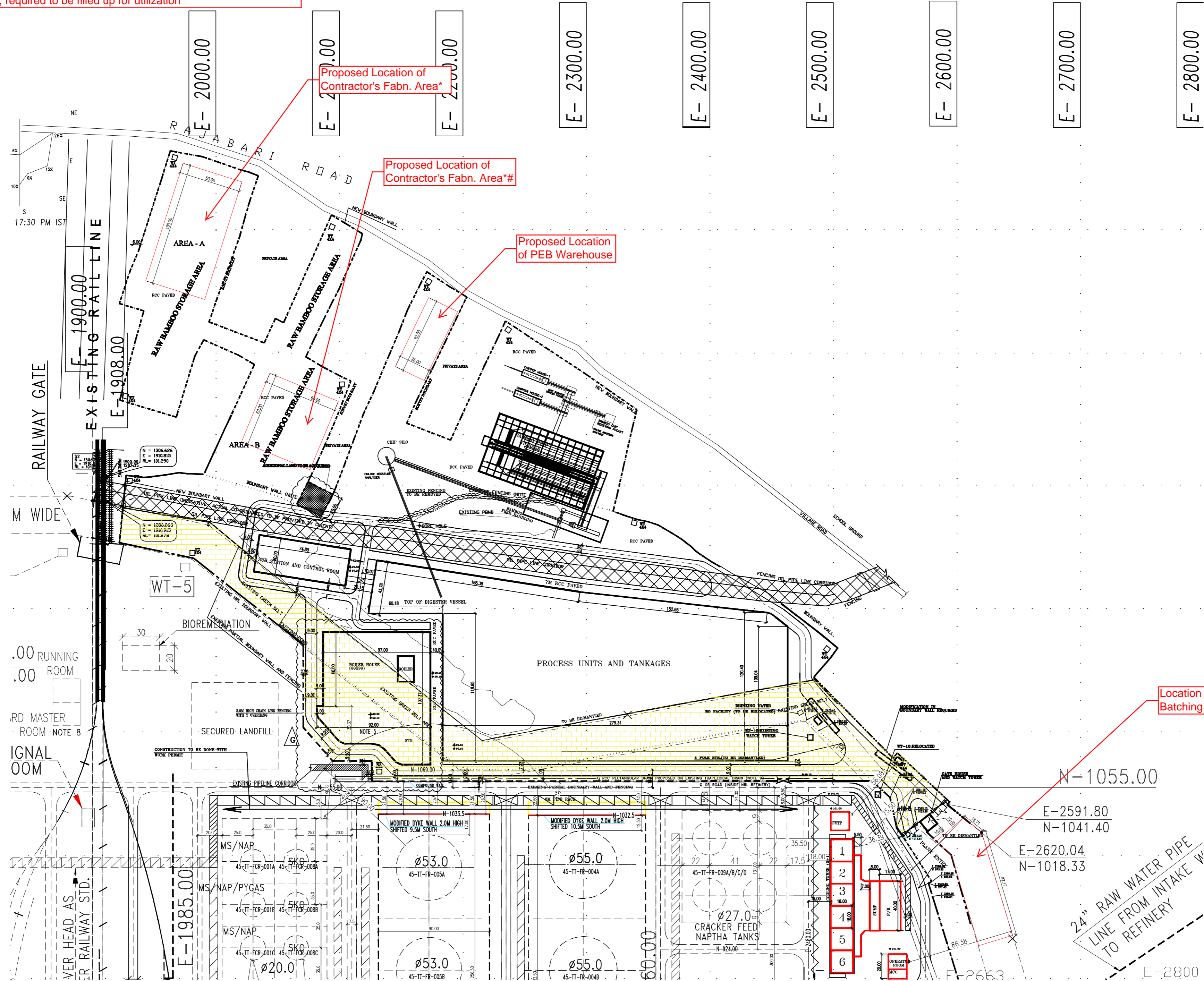

Proposed Location of Contractor's Fabn. Area*

Proposed Location of Contractor's Fabn. Area*#

Proposed Location of PEB Warehouse

Location for Batching Plant/s

24" RAW WATER PIPE
 LINE FROM INTAKE W
 TO REFINERY

